

### User's Guide

See the Zyxel website for a list of supported transceivers.

### Introduction

Use a transceiver module for connection to a remote device. SFP and SFP+ transceiver modules are hot swappable. You can install and remove a module while your device is operating.

SFP/SFP+ modules both use 3.3V power input and LC-type connectors.

SFP/SFP+ modules support data rate of 100M/1G/10G bps and single-mode/multi-mode connection based on its specification.

#### Handling Warning

All modules are static sensitive. To prevent damage from electrostatic discharge (ESD), it is recommended you attach an ESD preventive wrist strap to your wrist and to a bare metal surface when you install or remove a module.

All modules are dust sensitive. When not in use, always keep the dust plug on. Avoid getting dust and other contaminant into the optical bores, as the optics do not work correctly when obstructed with dust.

#### Safety Warning

All modules are equipped with a Class 1 laser, which emits invisible radiation. Read the following safety warnings carefully.

- To avoid possible eye injury, do not look into an operating fiber-optic module's connectors.

- Laser radiation is present when the device or system is powered up.

- Only trained and qualified personnel should be allowed to install or replace these modules.

#### Environmental Warnings

- Dispose of your fiber-optic module according to all national laws and regulations.

### 1 Installing a Module

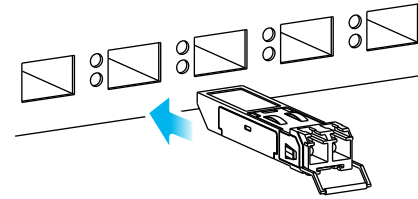

- EN**
- Attach an ESD preventive wrist strap to your wrist and to a bare metal surface.
  - Remove the a module from its protective packaging.
  - Locate the transmit (Tx) and the receive (Rx) markings on the module.
  - Align the module in front of the slot opening on a device.
  - Insert the module into the slot until the module snaps into place  
**Note** : Module installation orientation varies depending on your device. Your module comes with a mechanism that prevents incorrect insertion. Do NOT force or twist the module into a slot. Do NOT insert an SFP+ module into a 1-Gigabit SFP slot.

### 2 Connecting a Fiber-optic Cable

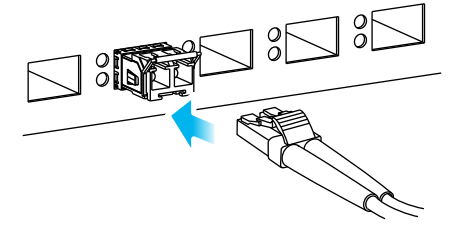

- EN**
- Remove the dust plugs from a module and the cables.
  - Identify the signal transmission direction of the fiber-optic cable and the module. Insert one end of the fiber-optic cable into the module.
  - Insert the other end of the fiber-optic cable into a remote device.  
**Note** : Refer to the user's guide that comes with your device for module slot status.

#### EU Importer

Zyxel Communications A/S  
Gladsaxevej 378, 2. th. 2860 Søborg, Denmark  
<http://www.zyxel.dk>

#### US Importer

Zyxel Communications, Inc  
1130 North Miller Street Anaheim, CA 92806-2001  
<http://www.us.zyxel.com>

Copyright © 2019 Zyxel Communications Corp. All Rights Reserved.



## Warranty Card

Thank you for purchasing Zyxel product, Zyxel has the great reputation in the market to provide best quality and performance on product and service to our customer. It is our pleasure to invite you to visit our website and register your product for receiving the latest Firmware, drive and product related information. If you still have further question or problem related to the product, please contact your vendor or our subsidiaries worldwide for further warranty information, kindly be noted the warranty terms may vary by regions, detail information is available on our website, please link to:  
[http://www.zyxel.com/support/warranty\\_information.shtml](http://www.zyxel.com/support/warranty_information.shtml)

### Purchase Information

Zyxel Product Name:

Hardware Serial Number:

Date of Purchase:

(In certain countries, the warranty will be validated with seller's signature and stamp):

...warranty must be validated with the seller's ...

### 1 Removing Fiber-optic Cable

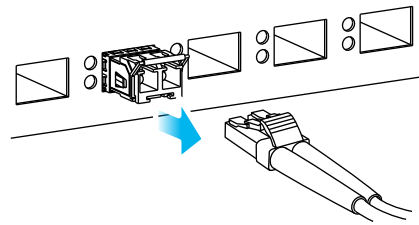

- EN**
- Attach an ESD preventive wrist strap to your wrist and to a bare metal surface on the chassis.
  - Disconnect all fiber-optic cables from the SFP/SFP+ module.

### 2 Unlocking a Module

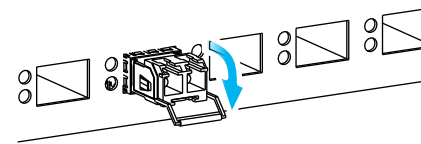

- EN**
- Insert the dust plug into the ports on a module.
  - Pull out the latch and down to unlock a module.

### 3 Removing a Module

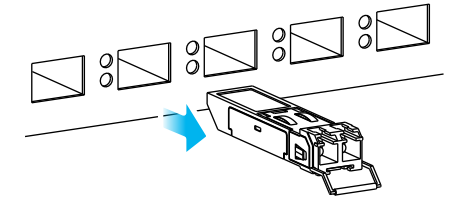

- EN**
- Using your thumb and index finger, grasp the tabs on both sides of the module and carefully slide it out of the slot.  
**Note** : Do NOT force or twist the module out of a slot.